

Döcke ROOT Pass-through element

1. Product description and usage.

Döcke Pass-through element ROOT (further – «product») is designed for organization of montage of Döcke ventilation spots on slope roofs, that are covered with bitumen shingles. The product is installed during the montage of bitumen shingles. The product is not designed for installation upon already installed bitumen shingles. Colors of the product – green (analog RR11), light-brown (analog RAL8017), red (analog RR29), grey (analog RR23), dark brown (analog RR32), black (analog RR33). The kit includes: the product, a template with installation guide and a set of screws in matching color.

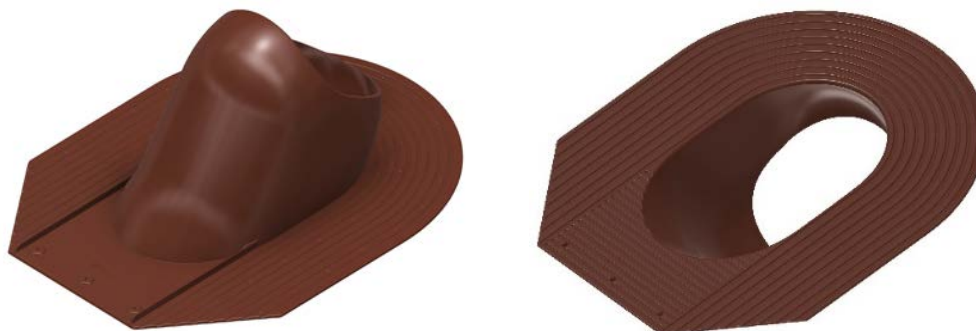

2. Geometrical parameters.

№	Indicators description, units measurements	Value
1	Length, mm	505
2	Width, mm	373
3	Height, mm	186
4	Min. angle, degrees	11*
5	Max. angle, degrees: - for pipe 110 mm - for pipe 125 mm - for pipe 160 mm	56** 55** 51**
* - swing around the ventilation output on 180° and cut the input hole if needed		
** - cut the output hole of the ventilation or canalization and pass element if needed		

3. Physical and mechanical properties.

№	Indicators description, units measurements	Value
1	Operating temperature range, °C	from -40 to +80
2	Impact resistance at t - 20° C	yes
3	Resistance to UV impact	yes
4	Raw material	polypropylene

4. Logistic characteristics.

№	Indicators description, units measurements	Value
1	Weight 1 piece, kg	0,58
2	Package weight (brutto), kg	7,4
3	Quantity in a package, pcs	9
4	Package dimensions (LxWxH), mm	990x490x400
5	Quantity of packages on a pallet, pcs	10
6	Weight of a pallet (brutto), kg	97,7
7	Pallet dimensions (LxWxH), mm	1200x1000x2200

5. Characteristics of the completed fixture.

№	Unit	Quantity, pcs
1	Painted roofing self-tapping screw with a press washer 4.8x35 mm and with a hexagon head 8 mm (for fixing the base)	3

6. Rules of storage.

- Transportation of products should be performed on vehicles with covered or tilted bodies.
- The goods must be stored only within manufacturer's original packaging
- The goods must be stored in conditions that prevent contact with moist and direct sunlight
- The goods must be stored only in indoor ventilated space, at temperature from -35°C to +50°C and relative air humidity 50-60%.
- In case of long-term storage (over 10 days) it is necessary to use pallets or racks. The height of boxes or packages stacked on top of each other must not exceed 1,5 meters.
- Strictly prohibited to store products:
 - without original packaging;
 - under direct sunlight;
 - in 1 meter or closer to heating devices